

Sarsfield Brooke Ltd.

SINCE 1998

Project Portfolio | Aug 2024 | Version 1

Inhouse Services Portfolio



Our Details

w: www.sarsfieldbrooke.co.nz

t: + 64 9 377 1502

a: Level 2, 155~165 The Strand, Parnell, Auckland 1051, New Zealand



[@sarsfieldbrooke](https://www.instagram.com/sarsfieldbrooke)



[@sarsfieldbrooke](https://www.facebook.com/sarsfieldbrooke)



[@sarsfieldbrookeltd](https://www.linkedin.com/company/sarsfieldbrookeltd)

Who are we?

Sarsfield Brooke Ltd

Sarsfield Brooke Ltd is a leading importer and wholesaler of furniture, lighting, and artwork to design professionals within New Zealand and internationally, with an exclusive representation of 14 globally recognised European brands.

Inhouse Design Services

Informed decisions, made with confidence.

With two tertiary qualified and experienced CAD designers added to the Sarsfield Brooke team, we now offer a more comprehensive in-house design service to assist with good decision-making and increased client confidence.

Matakana Residence

Project Scope and Brief

This award-winning Matakana Residence was the dream project for the Sarsfield Brooke team. Working closely with the architect and client for a complete and complimentary interior execution.

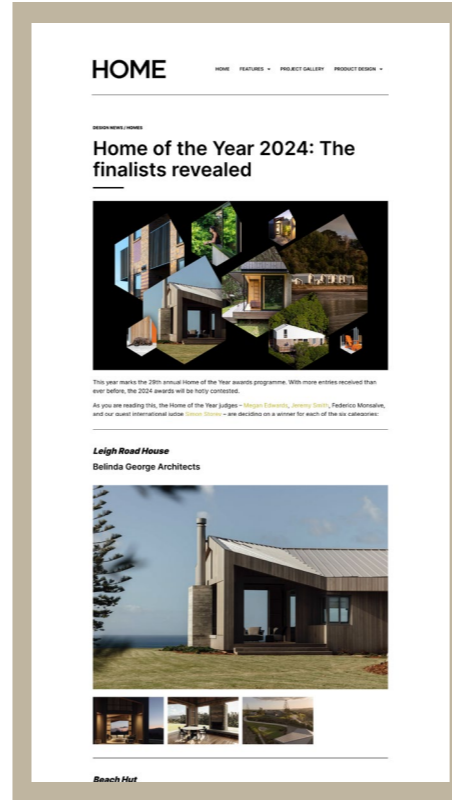

Architect's Vision

To begin, our sales & design team assembled the architect's chosen building materials, establishing a solid foundation for the subsequent design and implementation processes.



Spatial Planning

Preliminary Analysis of Space

Starting with a solid understanding of the space and identifying pathways, flow and use of space is the foundation of a well-designed interior. This is our first step in identifying the ideal furniture pieces and placement.

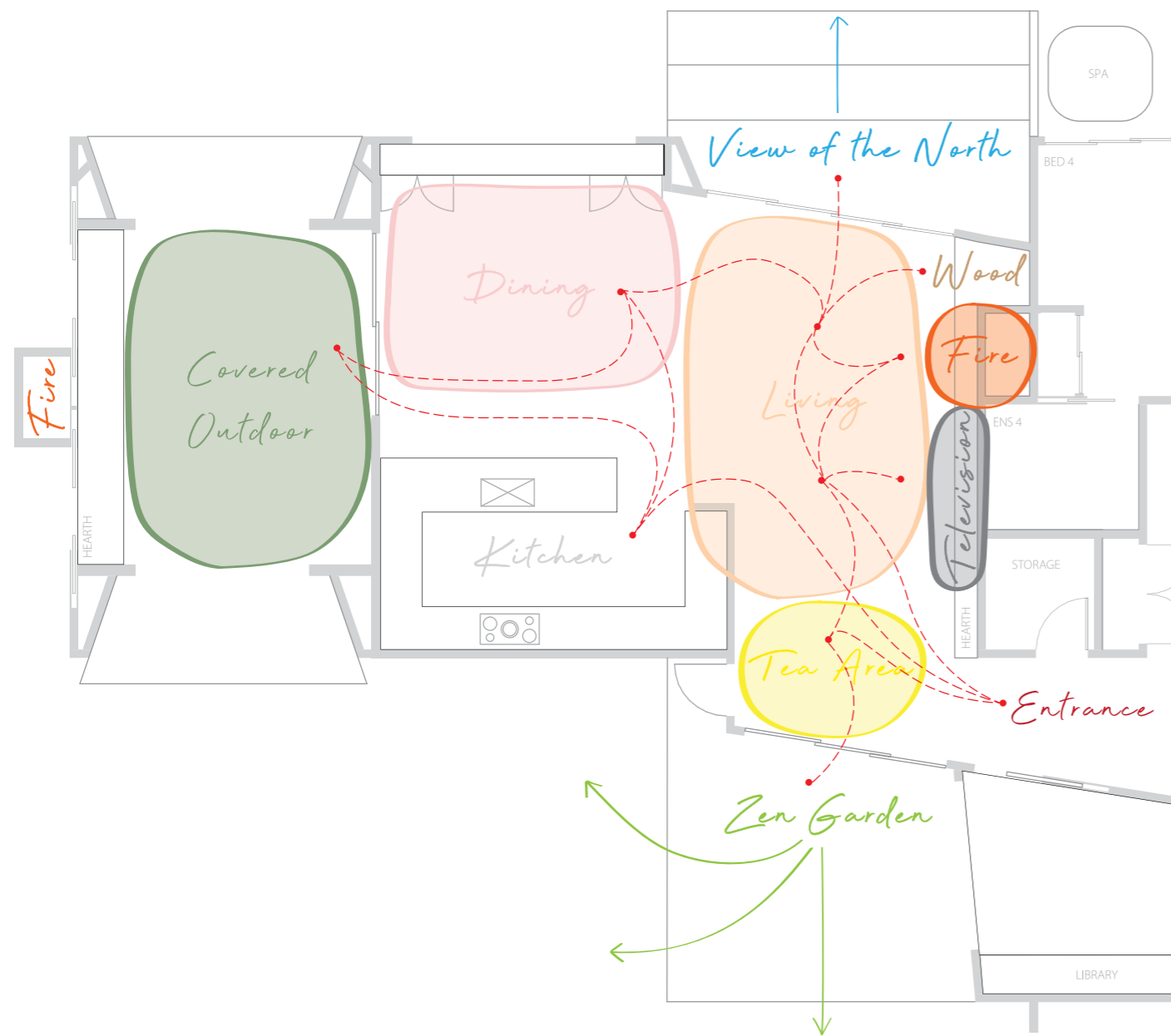

Layout Options

Building on the knowledge garnered from our spatial flow plan and the furniture the design professional and client are drawn to, we can create options of actual floor plans with preferred recommendations.

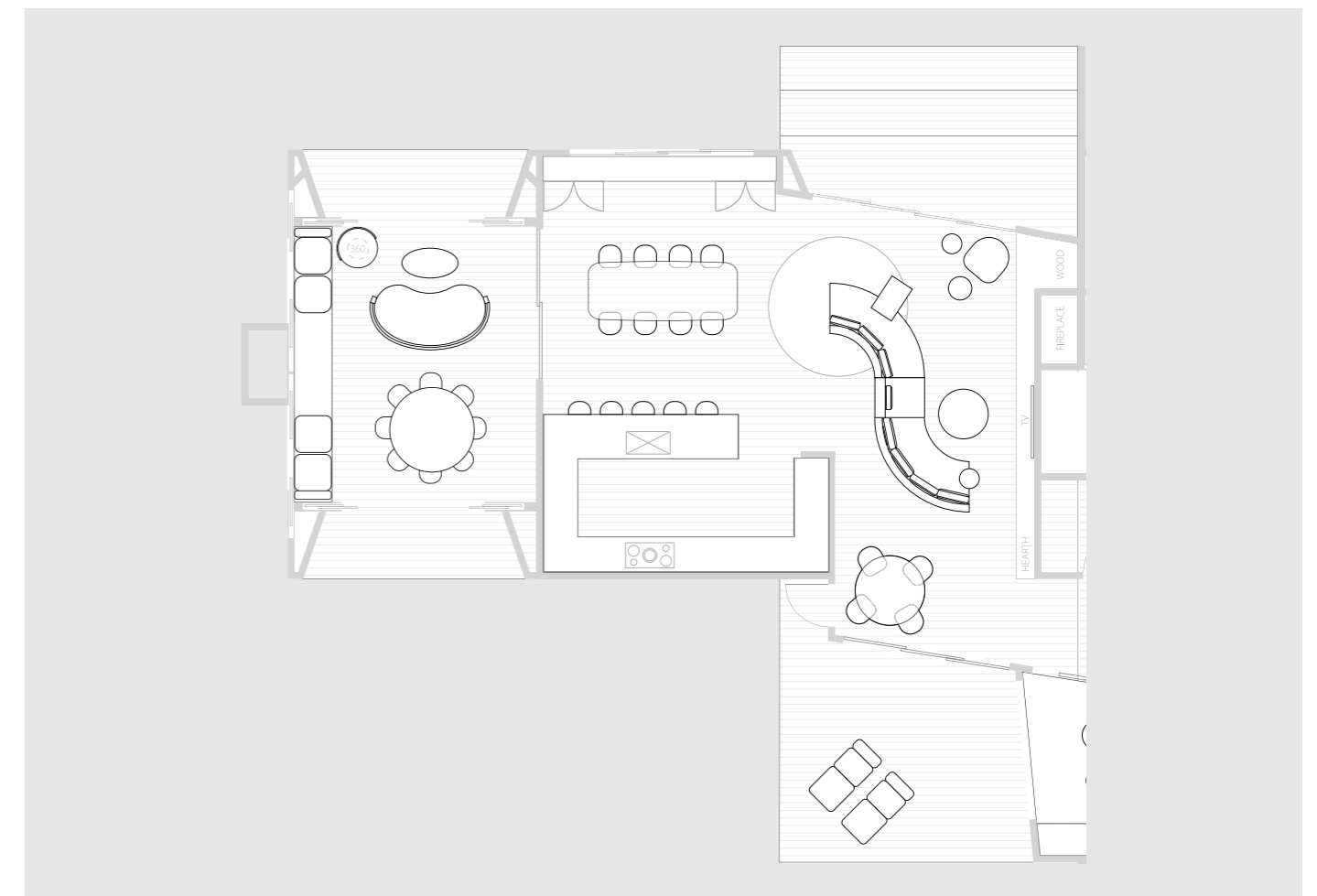
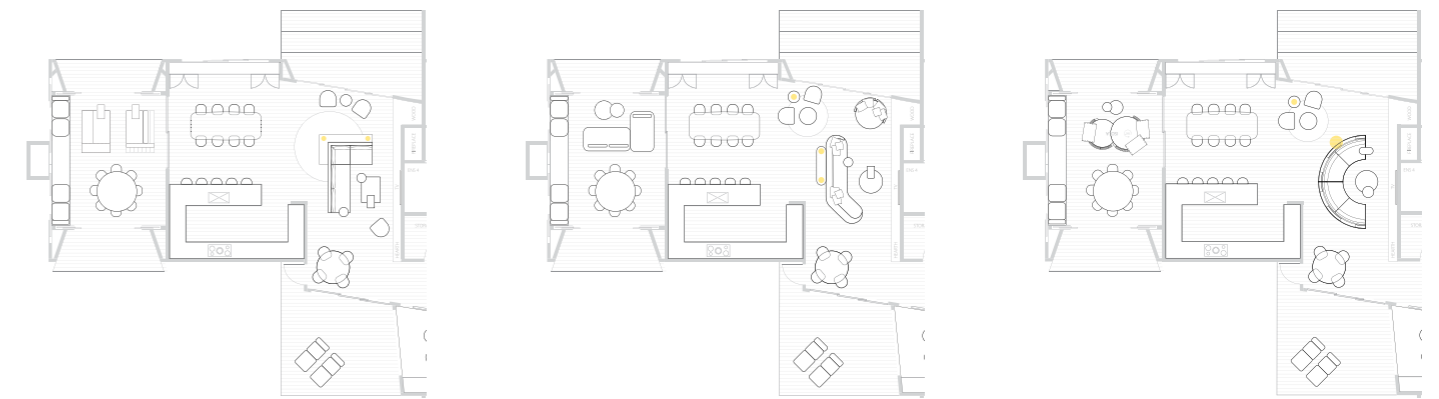

Layout Plan



Furniture & Fabric selection

Living Room & Tea Area

Mood boards are built to include actual choices in furniture and fabric – which also highlights our strength in customisation for any project.



Fili d'erba
Manufactured by
Reflex of Italy

Sit Dining Chair
Manufactured by
Reflex of Italy

Frame Coffee Table
Manufactured by
Giulio Marelli of Italy

Break Side Table
Manufactured by
Giulio Marelli of Italy



Quartzite
Existing

Timber Flooring
Existing

Matheus Sofa
Manufactured by
Giulio Marelli of Italy

Frame Server Table
Manufactured by
Giulio Marelli of Italy

Blobb Swivel Armchair
Manufactured by
Bullfrog of Germany



Zen Rug
Designed by SBL
Made in NZ

Electric Blue
Artist Javier Torres By Novcuadro of Spain



Furniture & Fabric selection

Dining Room & Kitchen

Wanting to maintain a feeling of calm, the client wanted her interiors to incorporate blacks and greys while keeping a connection to the earthy elements of the structure.



Lea Barstool
Manufactured by
MIDJ of Italy

Segno Dining Table
Manufactured by
Reflex of Italy



Sit Dining Chair
Manufactured by
Reflex of Italy



Quartzite
Existing

Timber Flooring
Existing



Cabinetry & Wall paint
Existing



Mars Artwork
Artist Javier Torres
by Novocadro of Spain



Labo Floor Lamp
Manufactured by
Penta of Italy

Donna swivel armchair
Bullfrog of Germany



Arkel Side Table
Manufactured by
Opera Contemporary of Italy



Fireze Console
Designed by SBL
Made in NZ

Furniture & Fabric selection

Outdoor Lounge & Dining

The outdoor spaces needed to be suitable to withstand the elements and maintain the natural Zen outdoor calm. To not compete with the view or the structure of the home.



Lagoon Sofa & Stool
Manufactured by Bullfrog of Germany

Johann Functional Seat
Manufactured by Bullfrog of Germany



Yao Swivel Chair
Manufactured by Bullfrog of Germany



Traventine
Existing

Limestone
Hearth
Existing



Cedar Walls
& Decking
Existing

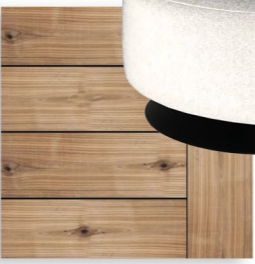

Nene Dining Chair
Manufactured by MIDJ of Italy



Break Dining Table
Manufactured by Giulio Marelli of Italy



Custom Furniture

Designed by Sarsfield Brooke, Made in New Zealand

Sarsfield Brooke has a strength in full customisation of our own collection such as table lengths, sofas, and ottomans. With a wide variety of fabrics and materials, your piece will be uniquely tailored to your space.

Our exclusive design + make service includes headboards, beds, wooden furniture pieces, and rugs – all made locally in Central Otago. We use Revit and Rhino to create custom designs for products and spaces, meeting your exact needs.



Why work with us?

Sarsfield Brooke is not just in the business of supplying the most beautiful furniture items to New Zealanders.

We are in the business of providing solutions to maximise the flow, functionality, enjoyment, and visual beauty of any interior space.

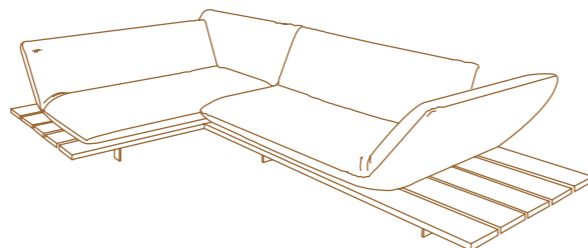

This diverse range of brands allows us to offer furniture solutions for a broad range of interior concepts, from contemporary to traditional, and for both residential and commercial projects. Our furniture selection is comprehensive whether you require practical and cost-effective options or highly sophisticated, custom-made pieces.

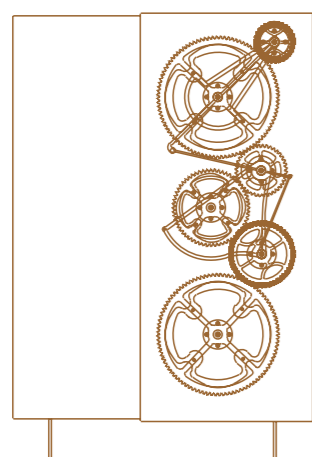
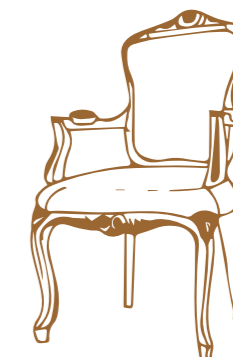

We work alongside design professionals and their clients to create the perfect pieces for the spaces that hold us.

Sarsfield Brooke Ltd, established in 1998 and based in Auckland, New Zealand, is a leading importer and wholesaler of furniture, lighting, and artwork to design professionals within New Zealand and internationally.

Sarsfield Brooke Ltd.
Level 2,
155~165 The Strand,
Parnell, Auckland

Our in-house design services with two tertiary qualified and experienced CAD designers and a sales team with decades of experience can provide clients with expert guidance and advice to create unique and personalised spaces.

With an exclusive representation of 14 globally recognised European brands, our selection has been carefully curated based on their exceptional attention to detail, top-quality production, and commitment to standing behind their products.

14 Exclusive representation of globally recognised European Brands

We also offer delivery and installation to make the process as stress-free as possible. From initial design concepts to final installation, Sarsfield Brooke Ltd is committed to delivering exceptional service and quality products every step of the way.

Hours
Mon ~ Fri
8.30 am~4.30pm

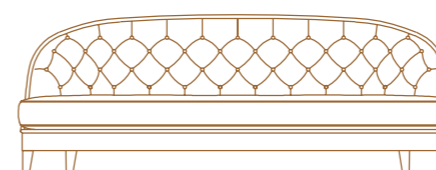

Our focused & highly skilled team welcomes you to our showroom, where undercover car parking is available.

Quay West Commercial

Project Scope and Brief

SBL recieved the opportunity to work with Quay West's body coporate to re-vamp their 4-star boutique hotel within budget.

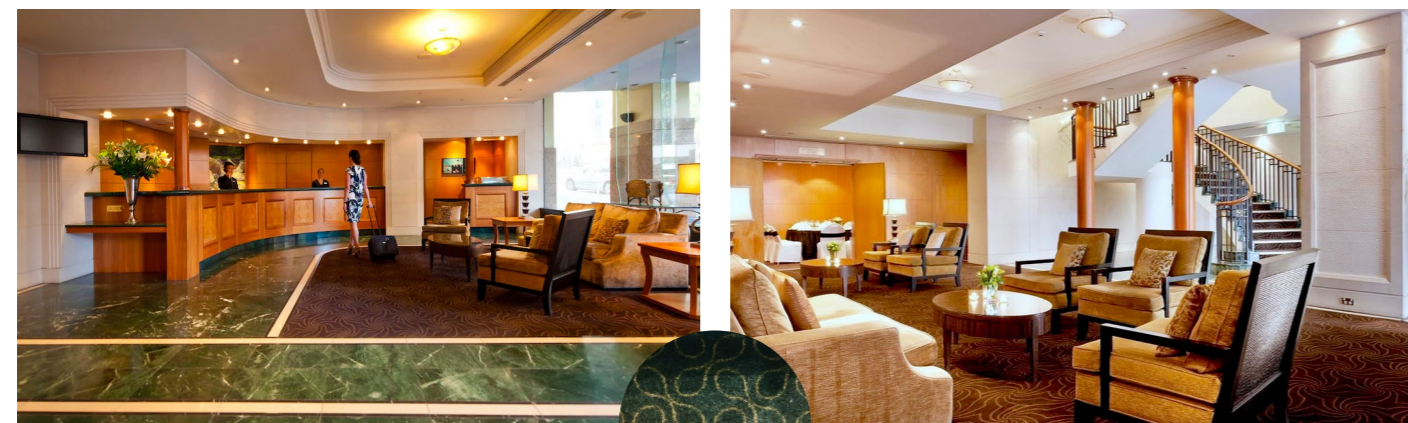
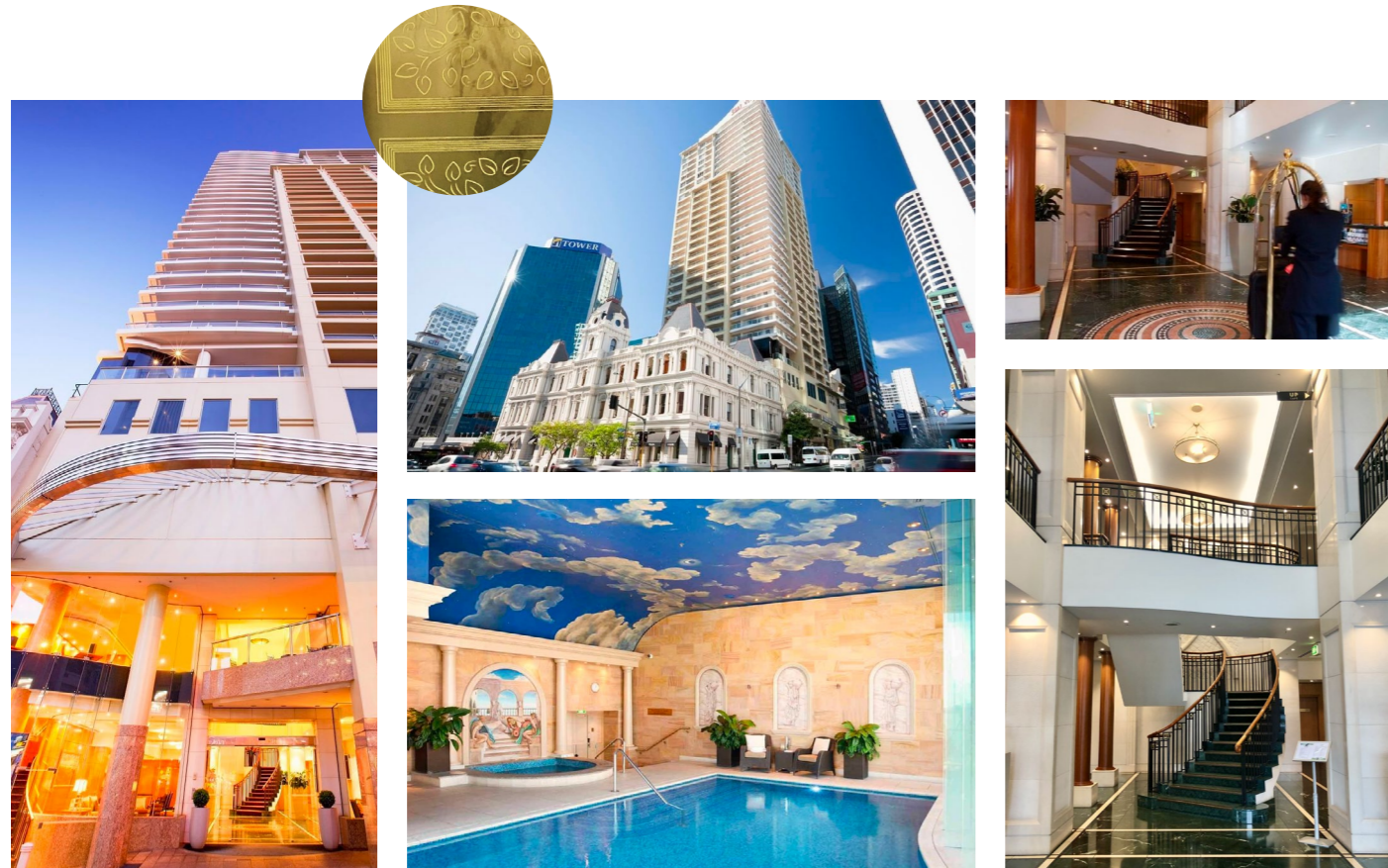

▲ Exterior, existing lobby & pool area

Design Narrative

To emphasise & modernise the art deco elements that is already present in the high-rise constructed in the 90s. To cater for all apartment owners & tenants, hotel guests, visitors, cafe customers, business meetings and car park leasers.

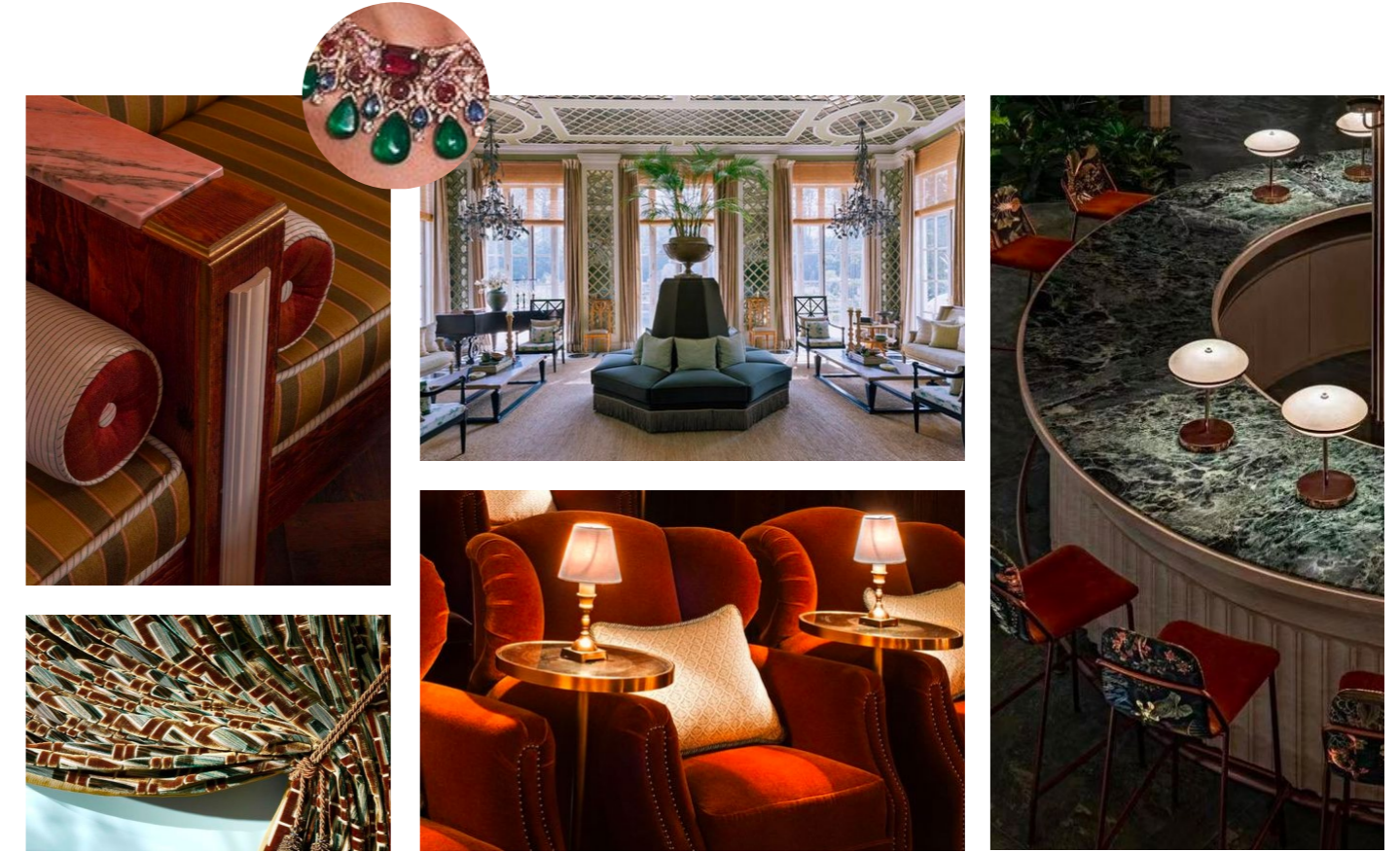

▲ Initial proposed visual identity

Spatial Planning

Project Scope and Brief

To create zones for various uses, offering a sense of privacy whether waiting to check in, meeting apartment guests or to work in a quiet area.

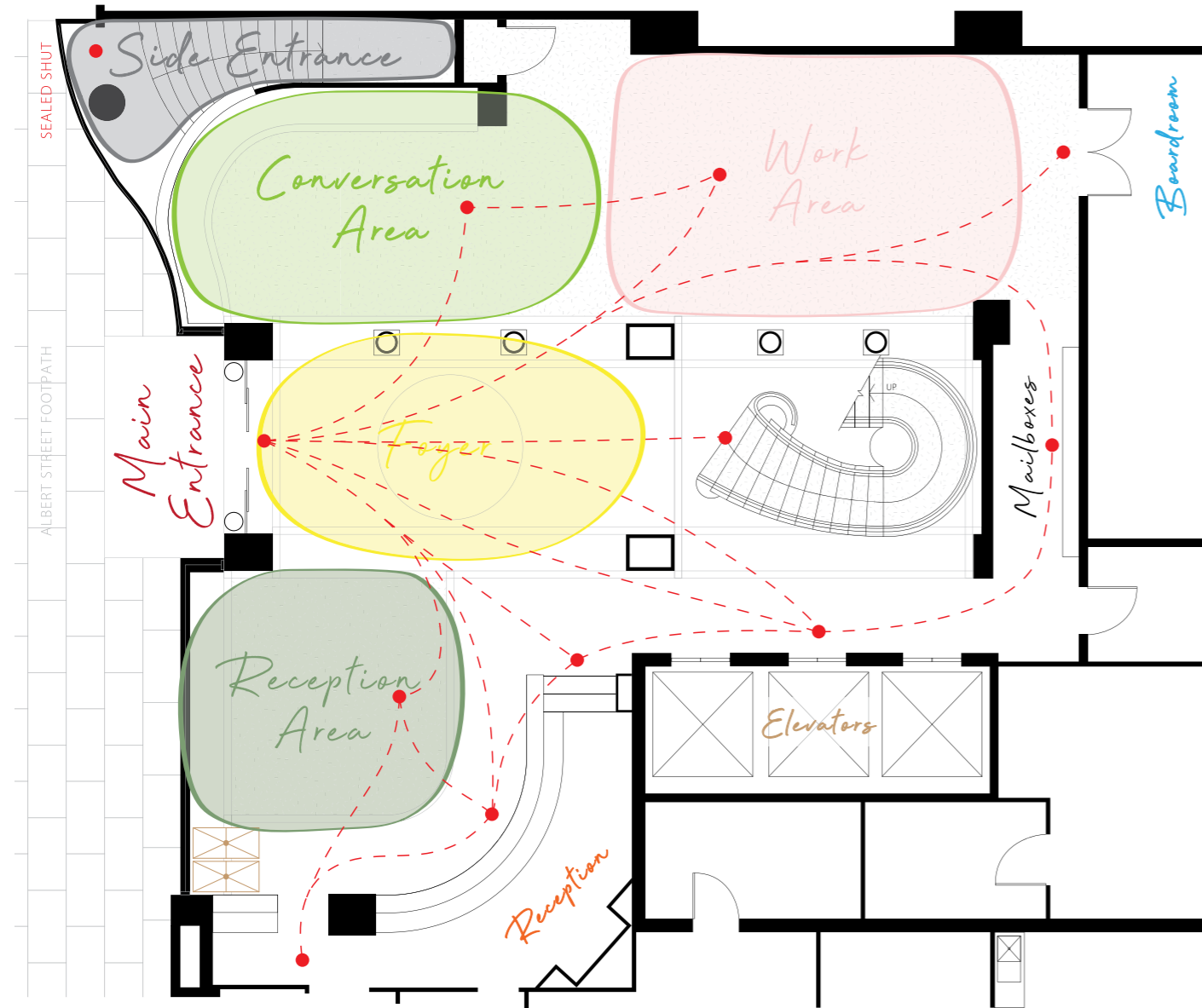

▲ Dotted red line showing typical path's of travel to each zone.

Layout Plan

Guidelines

Retain green carpet & marble floors, wood panel walls, reception desk, stairs & cast iron railing.



Proposed Visuals

Conversation Area & Side Entrance

The side entrance, which is not in use and sealed shut, is often mistaken by visitors to be the main entrance.

The idea was to black out the area, blending it away from the outside. From inside it creates a contrast backdrop for the conversation area.



▲ Proposed conversation area, looks through to the side entrance that is not in operation.



▲ Proposal of furniture in conversation area. Side entrance with feature wallpaper & lighting installation.



▲ Previous side entrance, view from exterior. Originally a restaurant entrance.

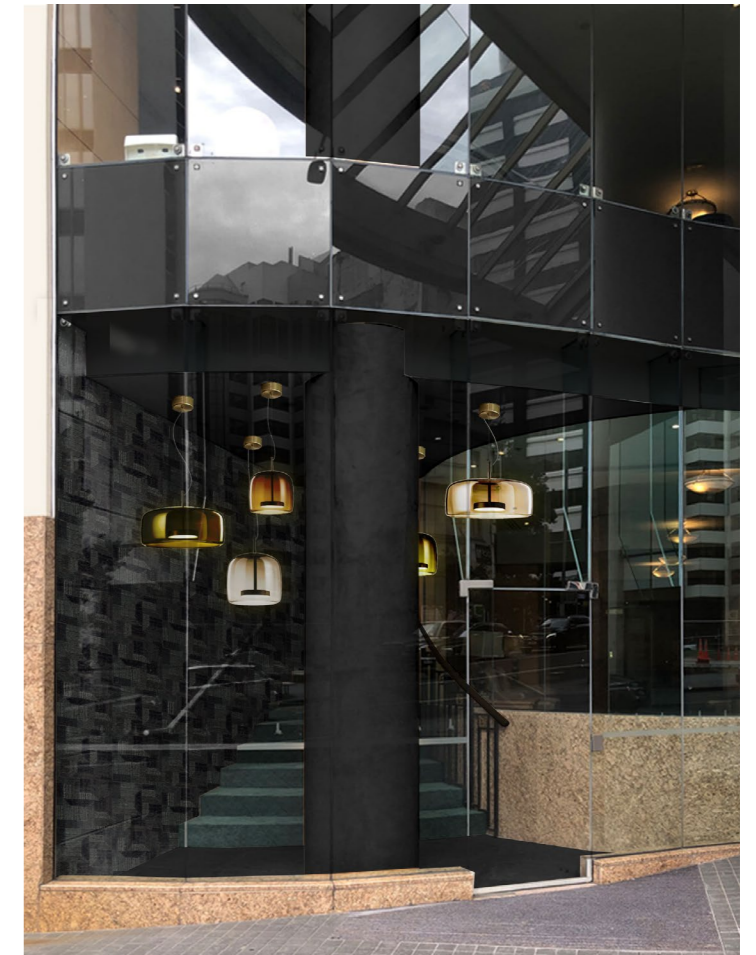

▲ Proposed design for side entrance. To camouflauge the appearance of the old entry.

Proposed Visuals

Elevator Concept

To reduce the yellow toned wood where permitted and inject luxury through texture. To enhance the art deco style by incorporating in more gold/brass tones paring it with black.



▲ Previous elevators, with yellowed wood tone and three mirrors, dark tiled flooring with marble inlay.



▲ Proposed elevator concept, featuring moire wallpaper, decorative metal panel inserts & round mirror.



▲ Final Elevator Design

Quay West Commercial

Final Installation

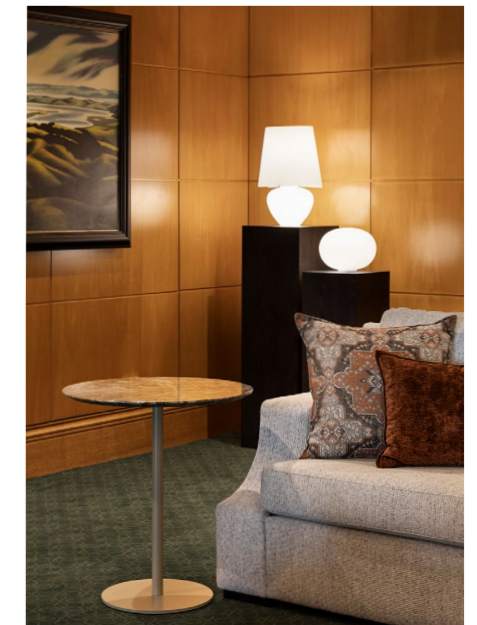
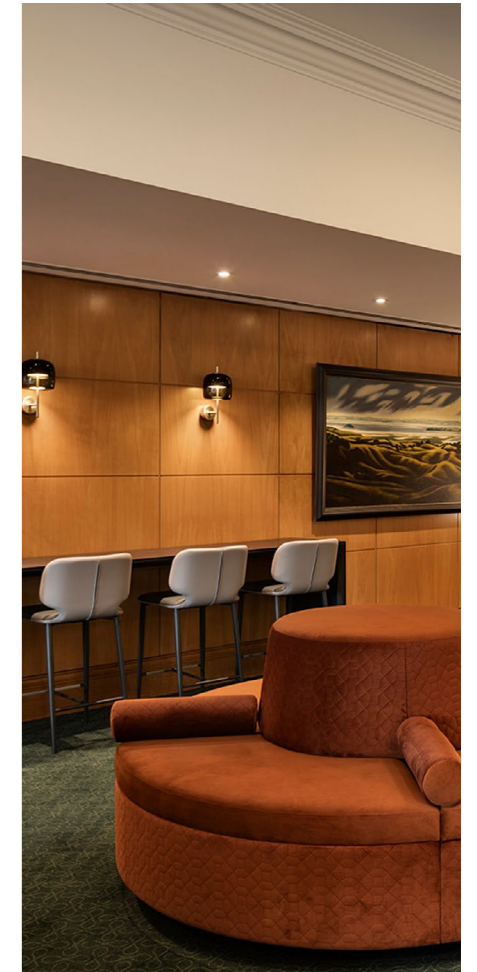

Our Projects

From residential to commercial, traditional to contemporary



SBL Collection

Our range of bespoke NZ made furniture - customisable



Ready to bring your vision to life?

We'd love to hear from you.

www.sarsfieldbrooke.co.nz | + 64 9 377 1502
Level 2, 155~165 The Strand, Parnell, Auckland 1051



[@sarsfieldbrooke](https://www.instagram.com/sarsfieldbrooke)



[@sarsfieldbrooke](https://www.facebook.com/sarsfieldbrooke)



[@sarsfieldbrookeltd](https://www.linkedin.com/company/sarsfieldbrookeltd)

